

The Trouville



Bontoft Avenue, Hull, East Yorkshire, HU5 4HF, United Kingdom.
T: 01482 475105 F: 01482 494301 E: sales@normandy-holiday-homes.co.uk



The Trouville

STANDARD FEATURES

- Insulation to floor
- Roof insulation
- Extra thick wall insulation
- Upvc Double glazed windows and doors
- Bay window configuration to lounge
- Extractor fan to kitchen
- Integral fridge freezer
- Free standing double cavity oven
- Integral larder fridge
- Pitched Pantile roof
- 'L' shaped lounge seating
- Gas lounge fire
- Free standing dining table and chairs
- Domestic internal doors
- Exterior light
- Extractor fan to shower room

OPTIONAL UPGRADES

- Fusion chassis
- Pull out bed to lounge seating
- Full central heating with thermostatic valves to radiators
- Pre galvanised chassis
- Four seasons insulation
- Hinged bed with storage
- Environmental external colours

'Made with Pride'

The Trouville introduces a whole new range of affordability never offered from Normandy Holiday Homes before, the Trouville creates a feeling of space, comfort and style not normally associated at this price level.

The lounge seating provides a sweeping 'L' shaped seating configuration making sure no matter how many you invite in there will be room for everyone, the dining area has a free standing table and upholstered chairs to seat 4 or 6, a provision normally reserved for larger homes.

Style and quality of build are features high on Normandy's must have list and the Trouville is no different, vaulted ceiling to the lounge, domestic contoured internal doors all topped off with a pantile roof make sure you will be more than impressed with the Trouville's combined quality and affordability.

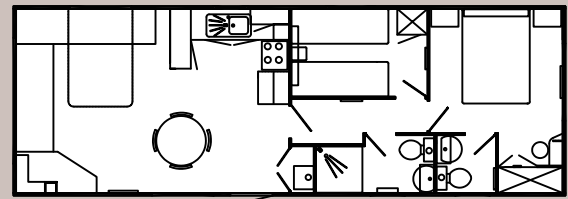

MODEL LIST

35 x 12 - 2 bed*

35 x 12 - 3 bed

* Floorplan shown as above

